

DANOloft®

PRE-PAINTED ACOUSTIC GYPSUM CEILINGS



KNAUF DANOLINE



IT'S NEVER BEEN EASIER TO ACHIEVE A STUNNING ACOUSTIC CEILING

DANOloft® pre-painted gypsum ceilings
make an attractive result quick and easy,
with excellent acoustic properties.





A CEILING WITH MULTIPLE BENEFITS

TURN UP THE **SPEED**

- Simple screw fastening
 - No painting or filling
 - Once installed, the ceiling is complete
 - Easy to demount or replace
-

TURN UP THE **DESIGN**

- Attractive, minimalistic look
 - Timeless Nordic design
 - Tiles can be repainted
 - Gypsum is a clean, robust material
-

TURN UP THE **ACOUSTICS**

- Sound is absorbed across entire ceiling
- Unrivaled acoustic effect
- Acoustic properties equal to other materials
- Healthy, pleasant indoor climate

RENOVATION OF 60s HOUSE



Once you are finished putting the tiles up, the ceiling is finished. It's a very simple process. The tiles are easy to handle and cut, because they are made of gypsum of course. The result is a neat, bright ceiling, with excellent acoustics and a discreet appearance.

STEFAN DANIELSEN
CARPENTER

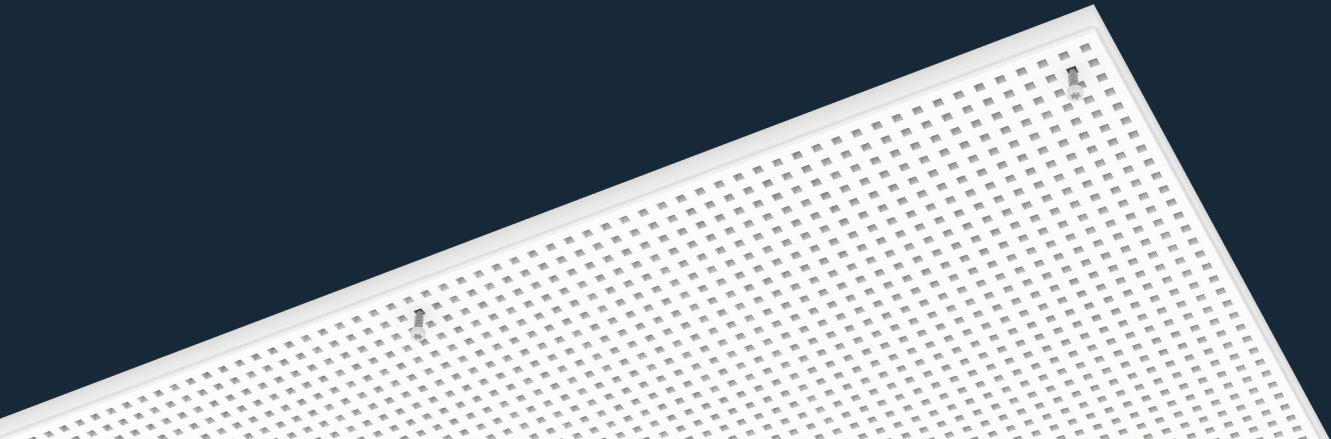



SIMPLE DESIGN AND FUNCTION

Format: 600 x 600 x 12.5 mm

Perforations: 17.2%, 3.5 x 3.5 mm

Colour: white painted / RAL 9003

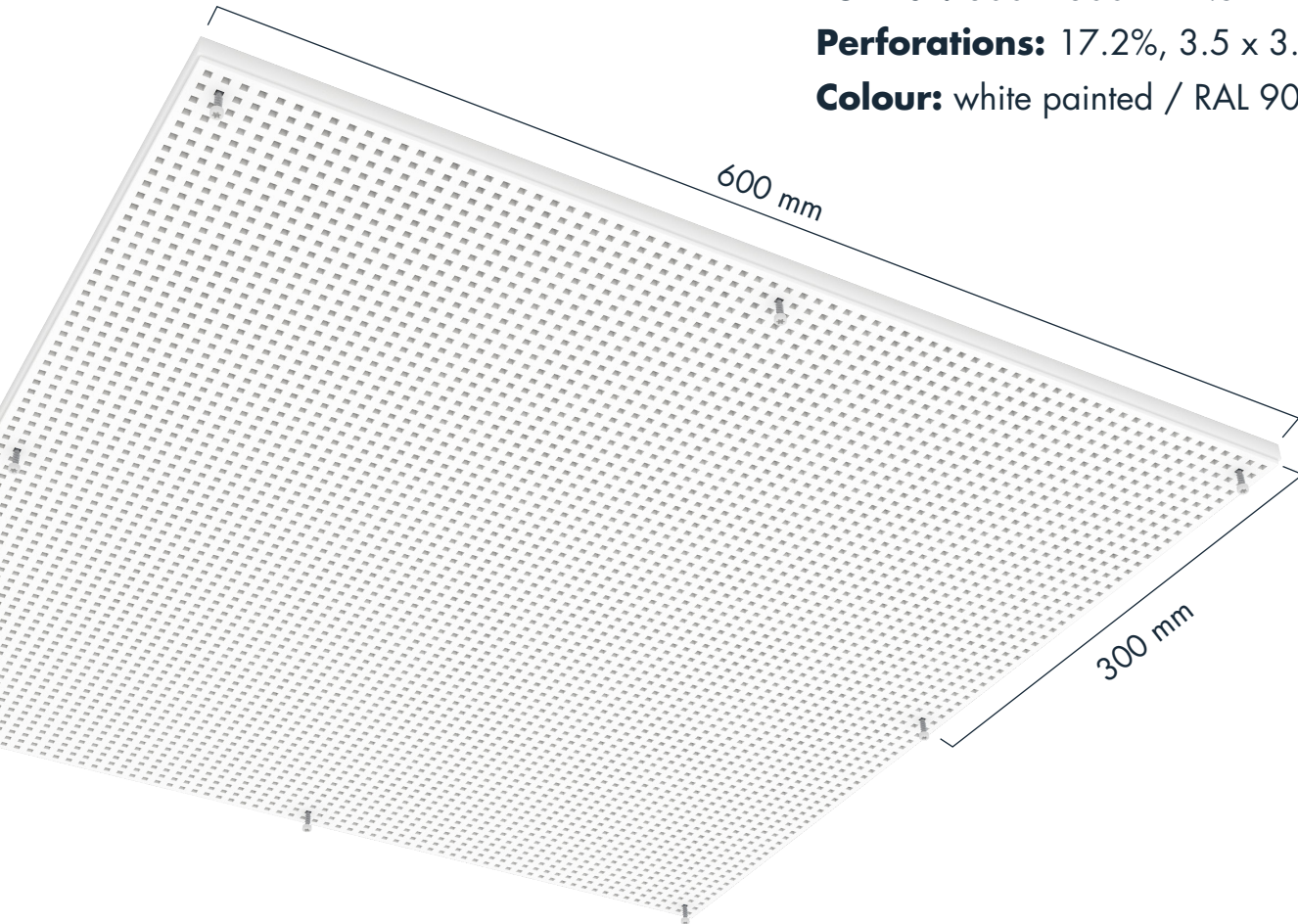

Recyclable choice: DANOloft® is made of gypsum - a natural material that is 100% recyclable.

Sound absorption: up to α_w 0.95

Fire class: A2 s1 d0

Light reflection: 69.2%





Size: 1200x600x12,5 mm

Perforation: 17,2%, 3,5x3,5mm

Colour: færdigmalet hvid / RAL 9003

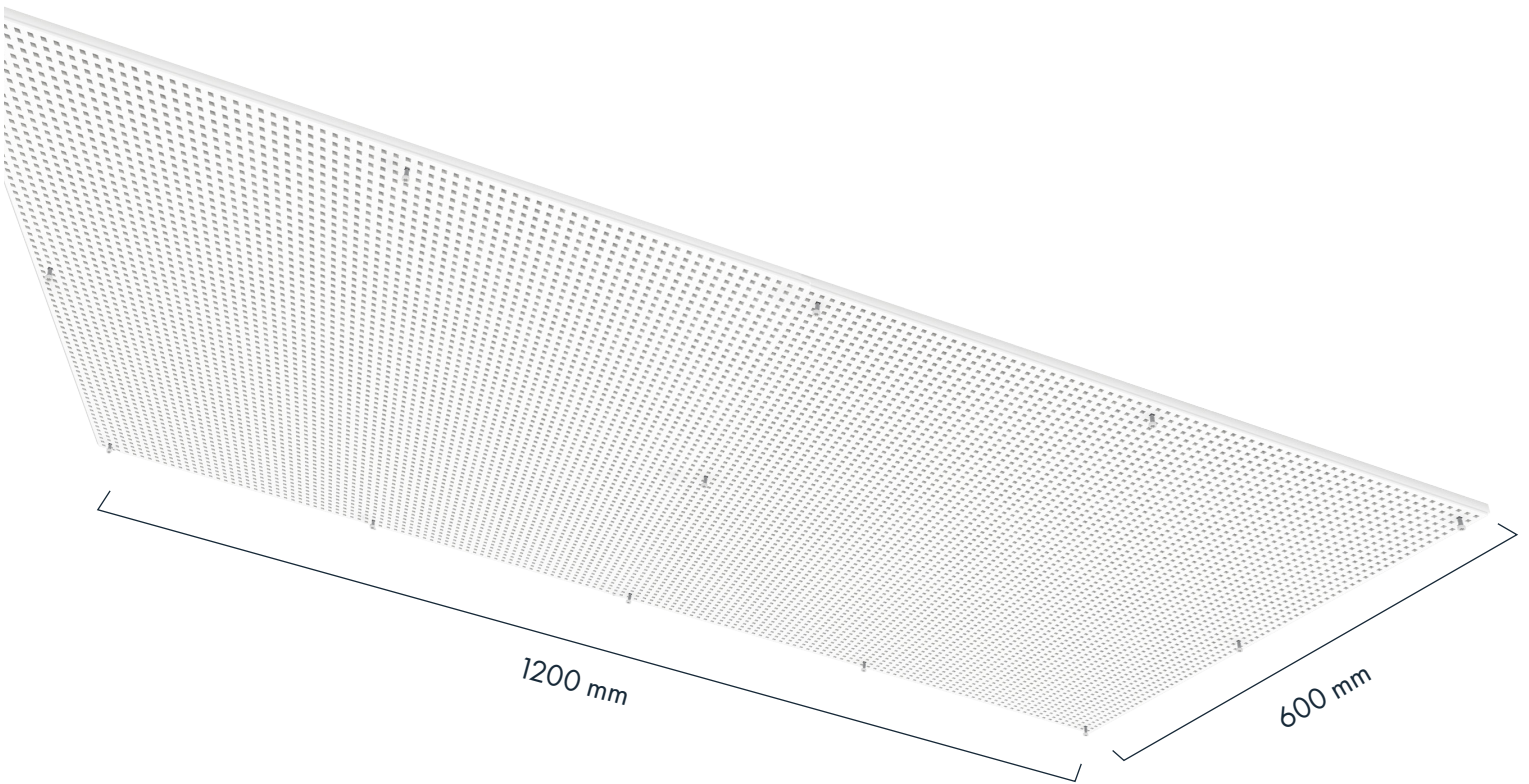

Sound absorption: op til α_w 0,95

Fire rating: K1 10, A2 s1 d0

Light reflection: 69,2%

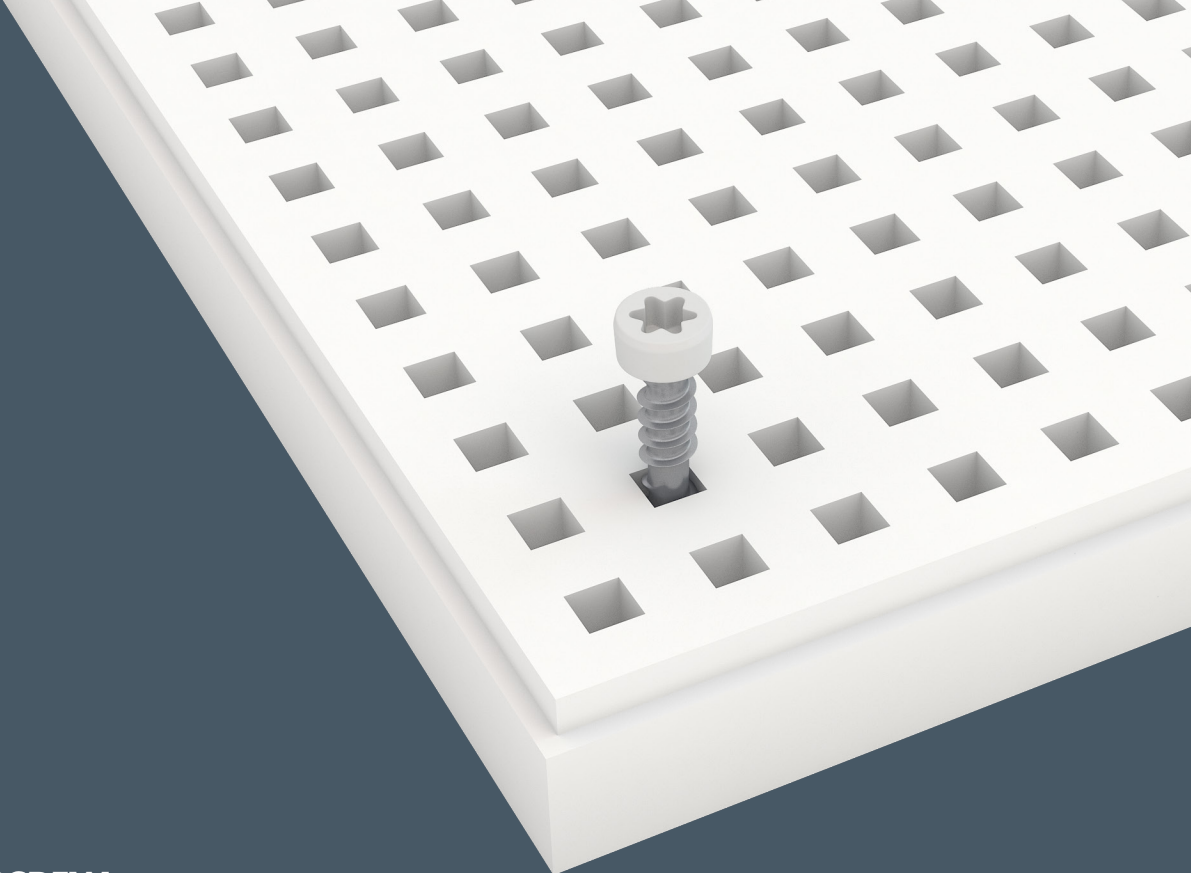

DANOloft® SCREW
ENSURES THE PERFECT FINISH

Torx 20

Requires no special tools. The Torx head also ensures that the screw blends in discreetly with the perforations of the tile.

Painted white

The screw head is painted white, making it almost invisible when flush with the tile surface.

INSTALLATION ON WOOD AND CONCRETE

Wooden structure

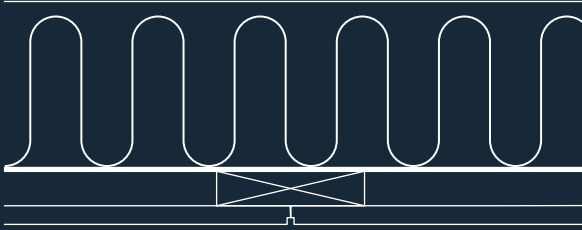

- Joists
- Damp barrier
- Furring 22 mm c/c 300 mm
- DANOloft®

Concrete structure

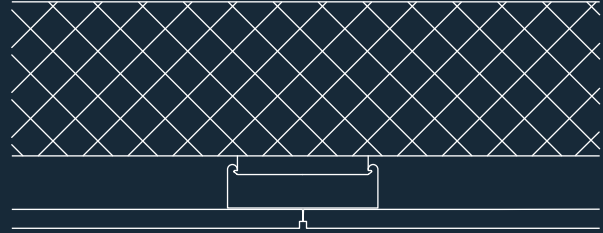

- Concrete slab
- CD profile 27/60 mm c/c 300 mm
- DANOloft®

Installing ceiling tiles

- Minimum 22 mm space behind the tile
- Insert the screws into the tile before installation
- Cut to size using a fine-toothed saw
- Screw must be flush with the tile surface
- Finish ceiling off with white acrylic joint filler



DIVIDING THE CEILING UP 600X600MM

Start installation of DANOlloft® tiles from the centre of the room.

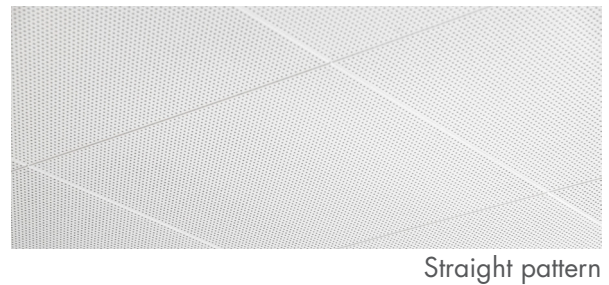
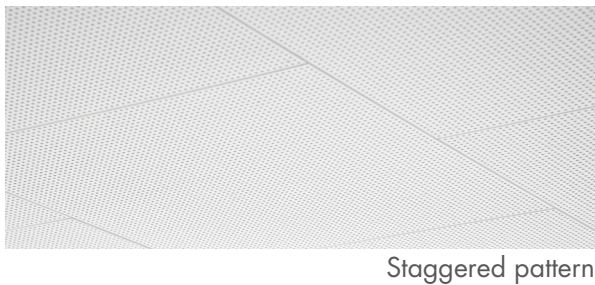
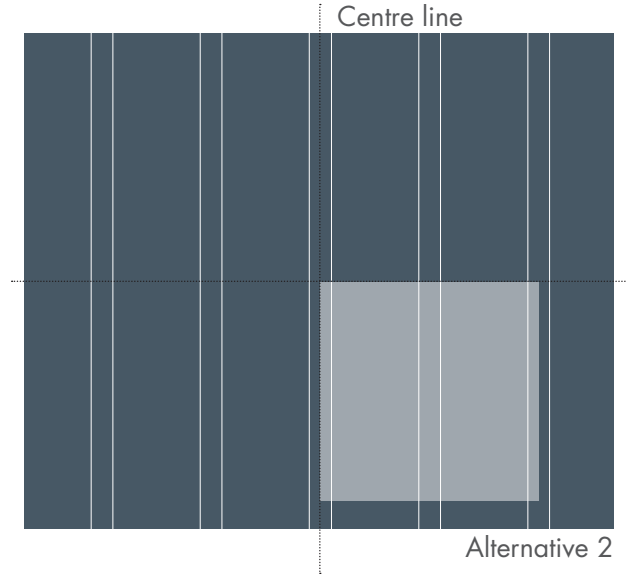
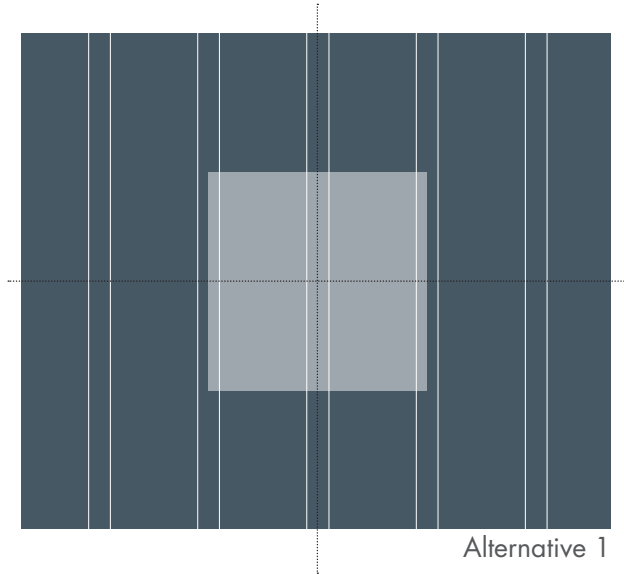

- Furring c/c 300 mm
- Furring width, min. 60 mm
- Furring thickness, min. 22 mm

See how-to video at

knaufdanoline.com/danoloft

DIVIDING THE CEILING UP 600X1200MM

Start montage af DANOløft® plader fra midten af rummet.

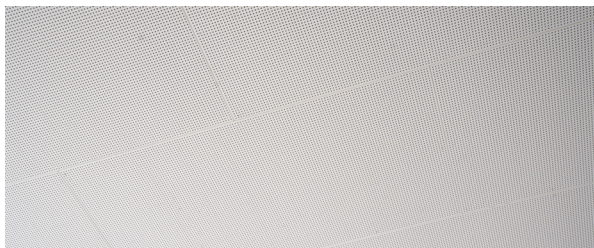
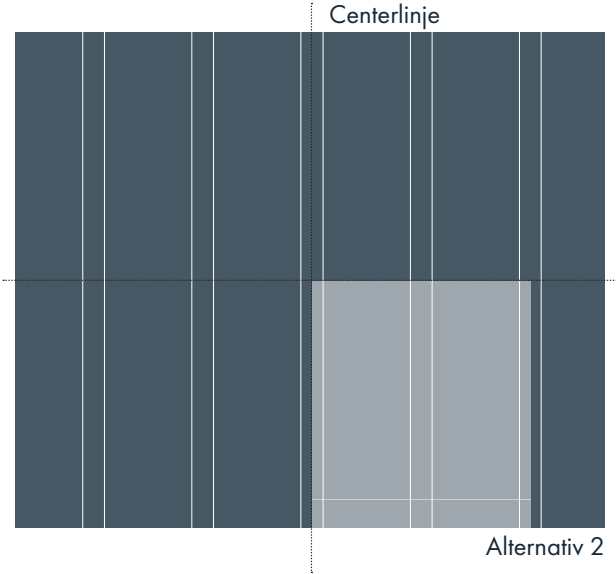
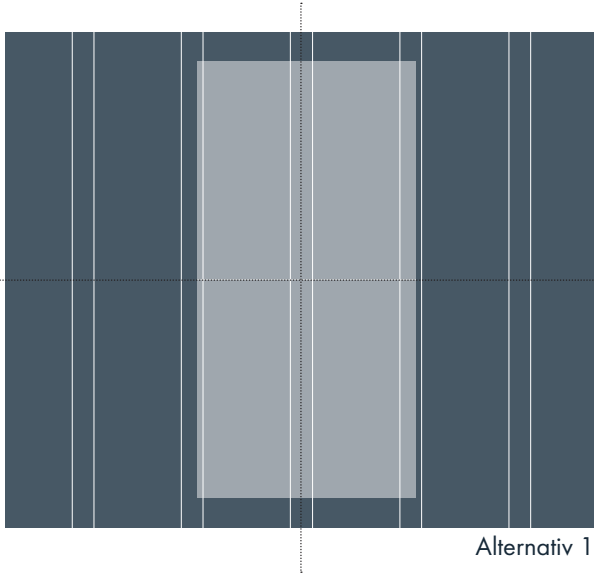

Halvforbandt montering

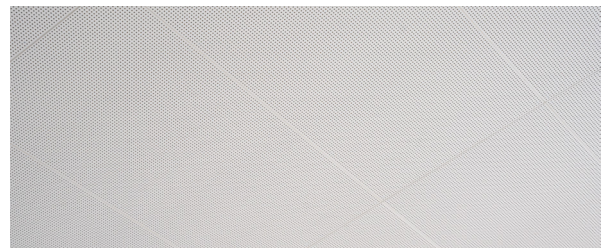

Lige stød montering

- Furring c/c 300 mm
- Furring width, min. 60 mm
- Furring thickness, min. 22 mm

See how-to video at

knaufdanoline.com/danoloft

Read more and
see how-to-video at
knaufdanoline.com/danoloft

KNAUF ***DANOLINE***