

INSTALLATION GUIDE

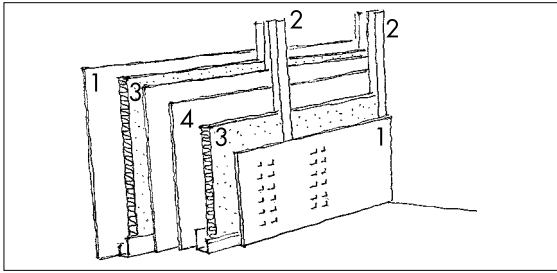

Components

- 1: Surface lining
- 2: Sonocare C47 profiles
- 3: 45 mm EcoBatt glass wool
- 4: 12.5 mm Silentboard Sonder

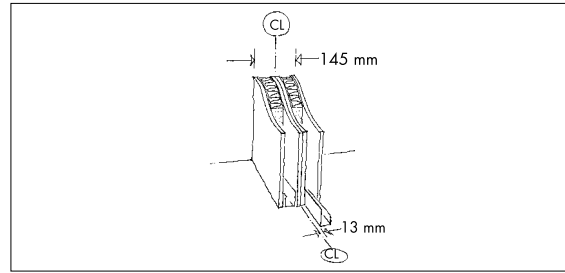

Mark out

- Mark out the centre line of the wall.
- Place Sonocare C47 profiles 13 mm from the centre line on the floor, ceiling and walls.

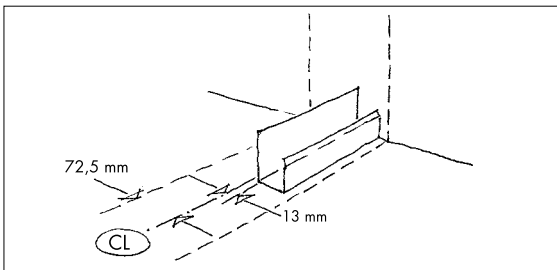

Profile direction

- The Sonocare C47 profiles are asymmetric with a long and a short flange.
- The long flange is always turned to the center of the wall.
- This goes for both sides of the wall.

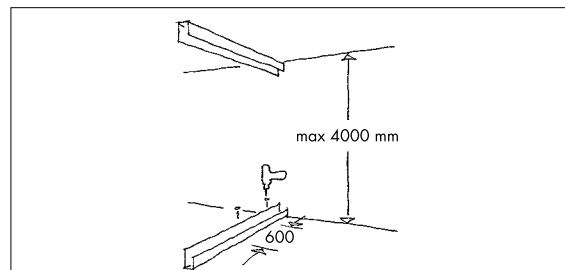

Mounting top and bottom profile

- Install the ceiling and floor profiles by screw fixing at max. 600mm. Choose the fixings in accordance with the substrate.
- The height of the wall is max. 4000 mm.

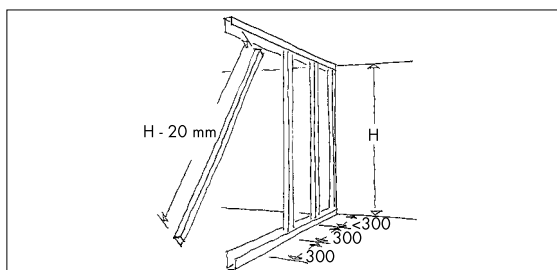

Cutting and mounting vertical profiles

- Cut the Sonocare C47 profiles so the length of the profile is 20 mm less than the wall height.
- Install the Sonocare C47 profiles at 300 mm c/c and with the flanges turning in the same direction.
- Fix the profiles to the top and bottom profiles using a stud crimping tool.
- Install the first and last profile to the adjacent walls by screw fixing at max. 600mm. Choose the fixings in accordance with the substrate.

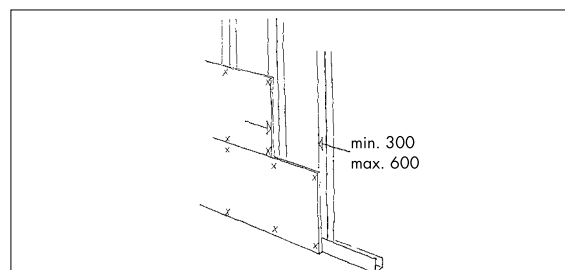

Installation of first center layer

- Install the first center layer of Silentboard Sonder.
- The joints of the boards must always be placed over a profile. The joints must be staggered by 300 or 600 mm.
- Secure the boards using a RA25 screw at 300 mm c/c horizontally and 600 mm c/c vertically.

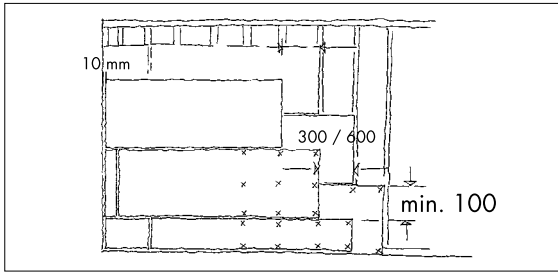

Installation of second board layer

- Install the second layer of Silentboard Sonder with a distance of min. 10 mm to all the adjacent surfaces.
- The joints between the Silentboards must be staggered according to the first layer. The distance must be min. 100 mm horizontally and 300 or 600 mm vertically.
- Secure the boards using a RA35 screw at 300 mm c/c in both directions.

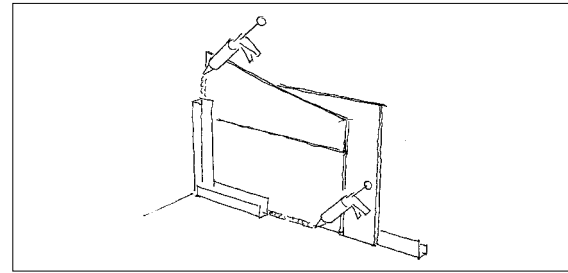

Installation of second profile layer

- Fill the 10 mm joint with Knauf Acryllic sealant no. 1.
- Install the floor and ceiling profiles and then the wall profiles
- Fix the profiles at max. 600 mm c/c. Choose the fixings in accordance with the substrate.

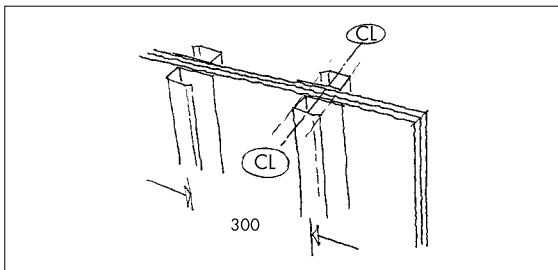

Installation of second profile layer

- Install the second layer of Sonocare C47 profiles directly opposite to the first layer of profiles aligned to the centre line of the short flanges.
- Turn the long profile flange in the opposite direction from the flange on the other side of the wall.
- Secure the profiles through the long flange into the boards using a G/R 25 screw at 600 mm c/c.

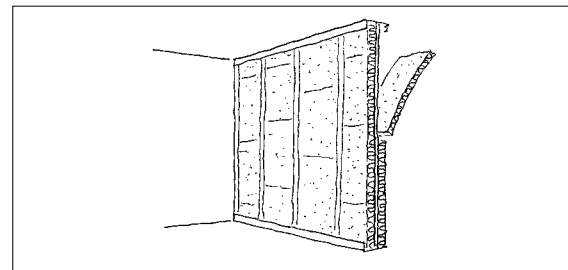

Installation of Ecobatt glass wool

- The EcoBatt glass wool elements are supplied in pairs with pre-cut slot between the two elements.
- Split the glass wool in two using a knife.
- Install the glass wool between the profiles on both sides of the wall.

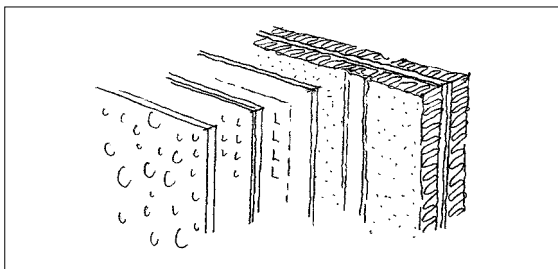

Installation of the surface lining

- The surface lining can consist of different types of perforated and non-perforated Knauf Danoline gypsum boards.
- Install the surface lining according to the installation guide of the chosen lining.

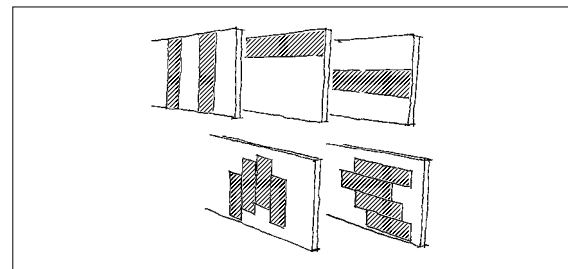

Surface lining design

- The design of the surface can vary in many different ways, depending on design and/or acoustic requirements.